



UHD Chassis Instruction Manual and Installation Guide

IMPORTANT INSTRUCTIONS

When using fiber optic equipment, basic precautions should always be followed to reduce the risk of injury to persons, including the following:

Read and understand all instructions.

1. Follow all warning and instructions marked on the product.
2. Laser light can be visible or invisible and can cause serious eye injury.
 - a. Do not look directly into the end of a fiber optic connector.
 - b. Do not look directly into the end of a fiber optic adapter having a fiber optic connector.
3. Install dust caps or plugs onto unused fiber optic connectors or non-shuttered fiber optic adapters.

Use an optical power meter to verify active fibers as necessary.

SAVE THESE INSTRUCTIONS

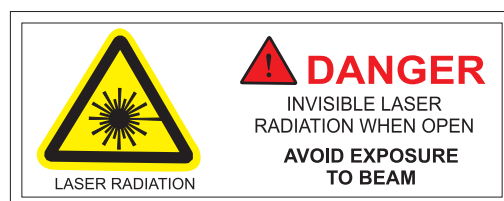

Contents in the Box - 2U

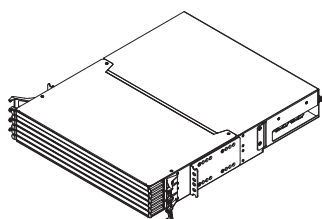

2U UHD Chassis with Extension

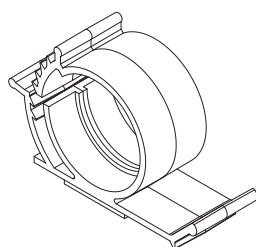

X 12

Rear Cable Clamp

Used to hold the Cable Rubber Grommet

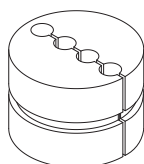

X 12

Cable Rubber Grommet

Used to grip cables of different sizes.

- 2.5 - 3.5mm (Standard)
- 3.5 - 4.5mm (Sold separately)

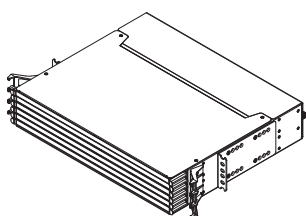

2U UHD Chassis without Extension

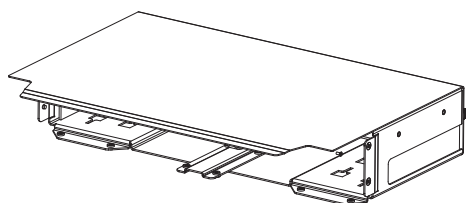

Extension Kit (optional)

Available only for chassis supplied with extension separately.

Contents in the Box - 1U

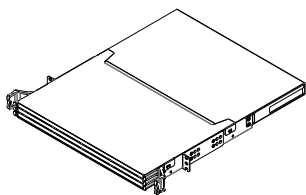

1U UHD Chassis with Extension

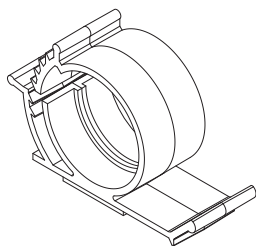

X 12

Rear Cable Clamp

Used to hold the Cable Rubber Grommet

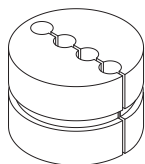

X 12

Cable Rubber Grommet

Used to grip cables of different sizes.

- 2.5 - 3.5mm (Standard)
- 3.5 - 4.5mm (Sold separately)

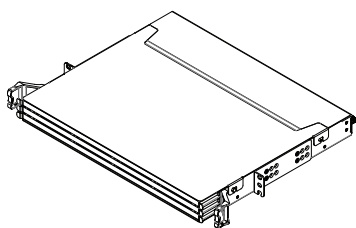

1U UHD Chassis without Extension

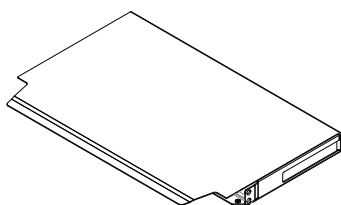

Extension Kit (optional)

Available only for chassis supplied with extension separately.

Ultra High Density Chassis

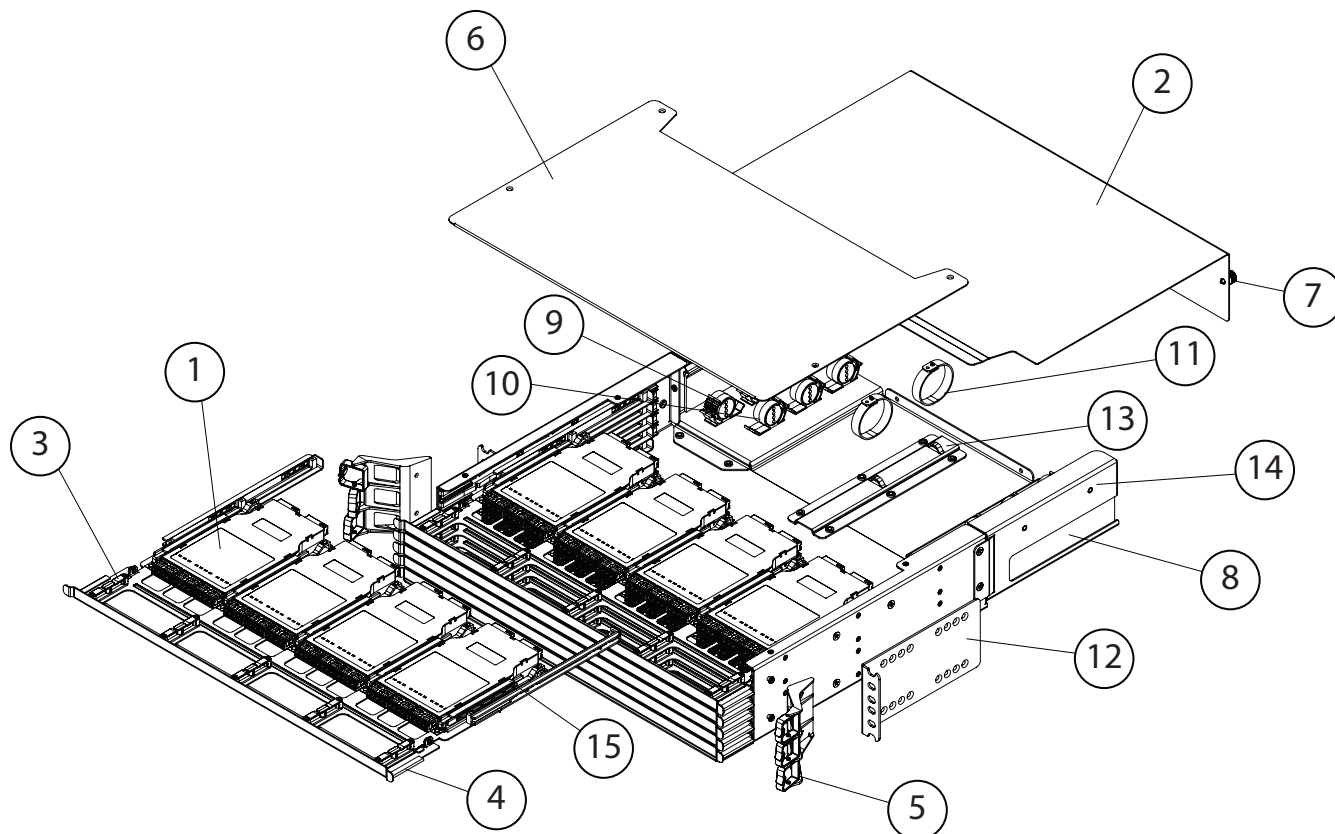

1. Cassette Module
2. Extension Lid
3. Front Cable Manager
4. Swing Door
5. Side Cable Manager
6. Chassis Lid
7. Thumb Screw
8. Brush Grommet
9. Cable Rubber Grommet
10. Rear Cable Clamp
11. Rear Cable Router
12. Mounting Bracket
13. Strengthening Member
14. Extension
15. Module Rail

Part Number	Product	Dimensions	Approx. Weight (lbs)(kgs)
DCP-UHD288E-XX	DataOpt UHD Chassis 2U With Extension	2U 3.50in x 17.13in x 22.25in	22.0 lbs (10.0 kg)
DCP-UHD144E-XX	DataOpt UHD Chassis 1U With Extension	1U 1.75in x 17.13in x 22.25in	15.4 lbs (7.0 kg)
DCP-UHD288-XX	DataOpt UHD Chassis 2U Compact	2U 3.50in x 17.13in x 15.25in	16.5 lbs (7.5 kg)
DCP-UHD144-XX	DataOpt UHD Chassis 1U Compact	1U 1.75in x 17.13in x 15.25in	12.1 lbs (5.5 kg)

-XX = optional colors "-BK" for Black; "-BS" for Bengal Silver

Tools and Cleaning Materials:

- Screwdriver (with 8-inch shank) for rack screws
- LC Connector/Adapter Cleaning Tool(s)
- MTP® Connector/Adapter Cleaning Tool(s)

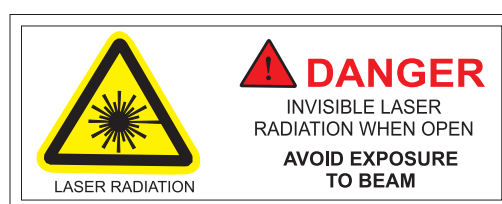

Open / Remove from Unit Carton

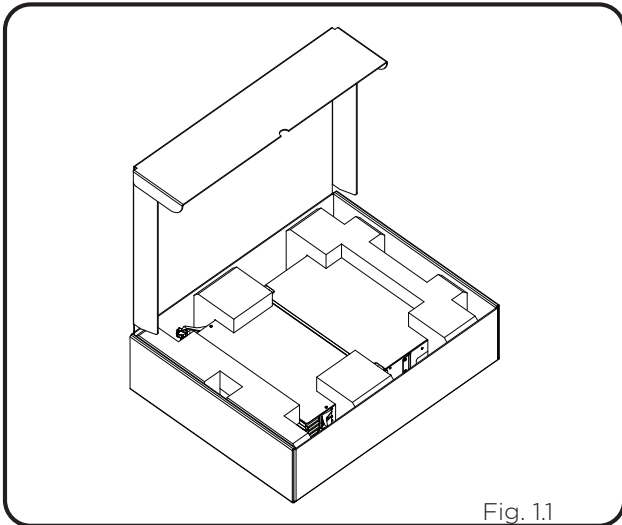

Fig. 1.1

- 1.5. Remove the PE Foam from the UHD Chassis; place the PE Foam inside the Unit Carton.
- 1.6. Remove the Poly Bag from the UHD Chassis; place the Poly Bag inside the Unit Carton.
- 1.7. Detach the extension lid by unscrewing the thumb screws on the back of the

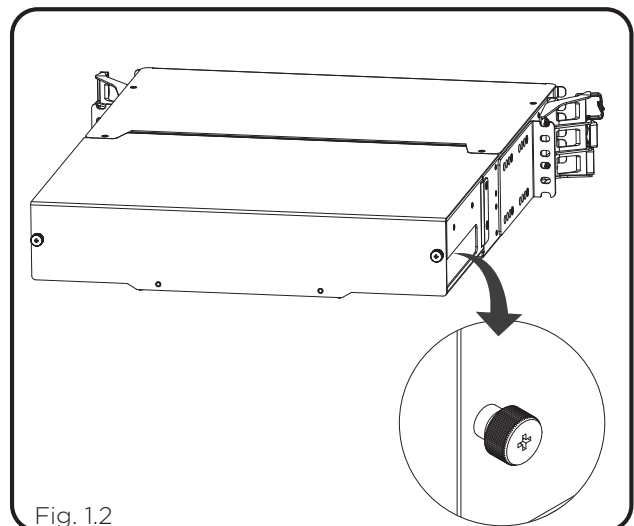

Fig. 1.2

UHD Chassis with Extension; remove any packaging materials placed inside the UHD Chassis with Extension

- 1.8. Set aside the Chassis Extension Lid for later installation.
- 1.9. Store or stack the UHD Chassis horizontally on its flat bottom surface; do not store or stack upside down, or vertically upright or edge-wise when not in use.

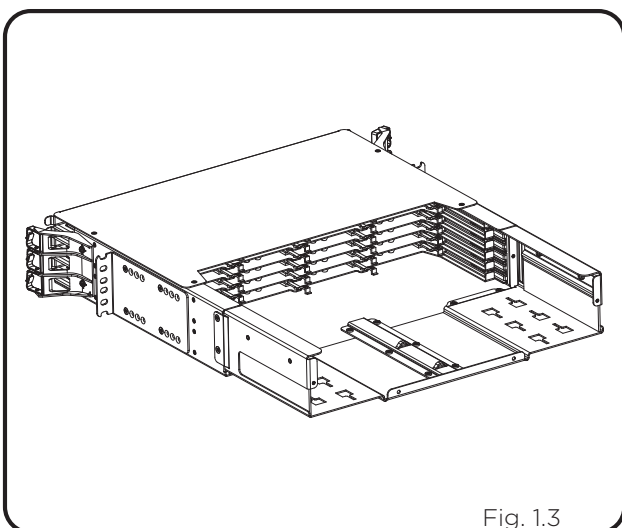
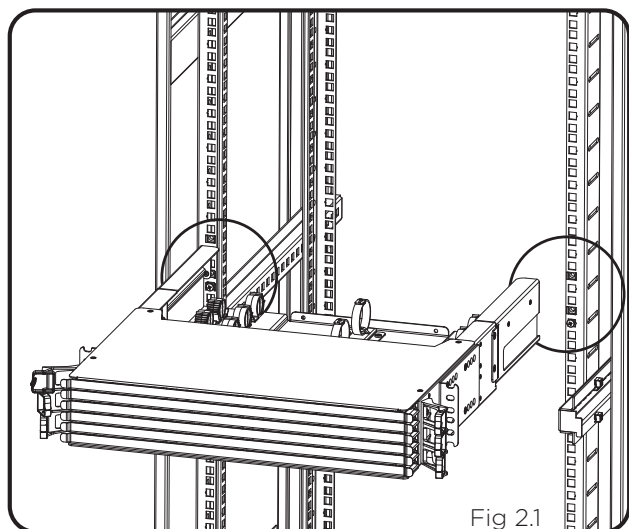

Fig. 1.3

Install into a standard 19-inch EIA-310 Rack



- 2.1. Adjust / verify the position of the rack mounting brackets on the sides of the UHD Chassis.
- 2.2. Identify the location in the rack/cabinet for the UHD Chassis.
- 2.3. Partially install (thread half-way) two rack/cabinet screws on opposite sides of the rack or cabinet, in the bottom location of the UHD Chassis screw locations. (Fig. 2.1)

2.4. Place the UHD Chassis into the rack/cabinet; rest the UHD Chassis onto the two screws. (Fig. 2.2) **Do not use the Side Cable Managers to lift, hold, or position the UHD Chassis during installation.**

2.5. Secure the UHD Chassis in the rack/cabinet:

2.6. Secure the 1U UHD Chassis in the rack/cabinet using a minimum of four (maximum of 6) rack/cabinet screws, having equal numbers of screws installed in the rack

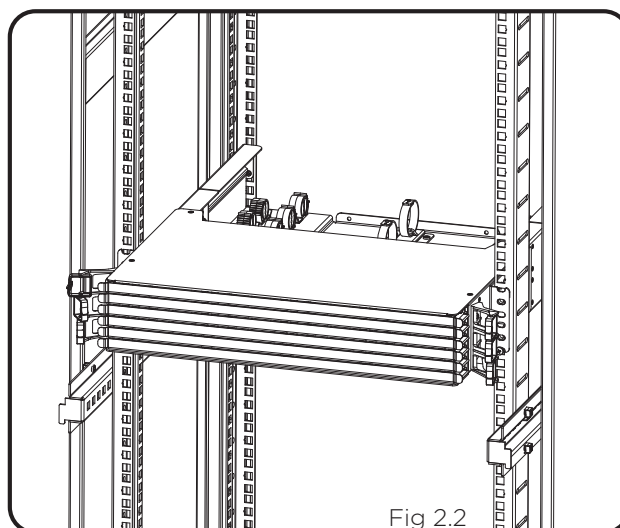

mounting brackets, in the same hole pattern on each side of the chassis.

- 2.7. Secure the 2U UHD Chassis in the rack/cabinet using a minimum of eight (maximum of 12) rack/cabinet screws, having equal numbers of screws installed in the rack mounting brackets, in the same hole pattern on each side of the chassis. (Fig. 3.3)
- 2.8. Remove the partially-installed screws from the rack/cabinet if they are not being used to secure the chassis to the rack/cabinet.

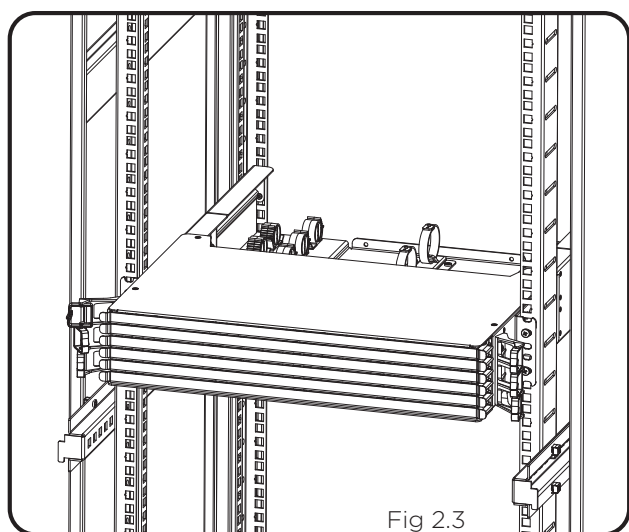

Cassette Module Installation – Front

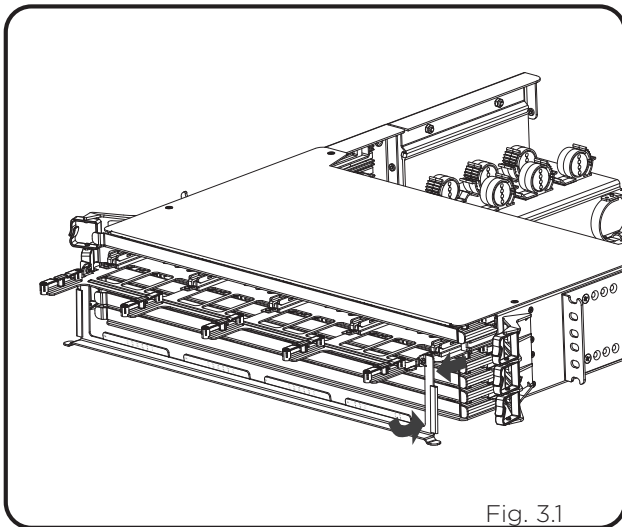

Fig. 3.1

Ensure that the Cassette Module is correctly oriented with “This Side Up” on the top surface. Make sure that the cassette rail is aligned perfectly to the slot in the module rail.

- 3.5. Slide the Cassette Module into the Sliding Tray until it locks into position.
- 3.6. Repeat as necessary until four Cassette Modules are installed into one Sliding Tray.
- 3.7. A Cassette Module can be removed if necessary by pressing down the Cassette Removal Lever and pulling the Cassette Module out of the Sliding Tray. (Fig 3.3)

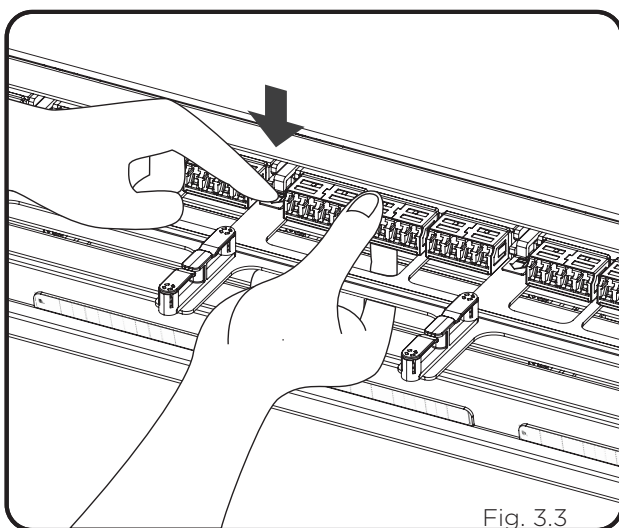

Fig. 3.3

- 3.1. Identify the Sliding Tray location for the Cassette Module(s) installation.
- 3.2. Pull both ends of the Swing Door straight out and level, with equal force, from the front of the UHD Chassis, until the Sliding Tray stops. DO NOT attempt to completely remove the Sliding Tray from the UHD Chassis.
- 3.3. Release the Swing Door (allow it to drop down) to reveal the Sliding Tray Cassette Module locations.
- 3.4. Insert one Cassette Module into an empty set of Module Rails on one Sliding Tray.

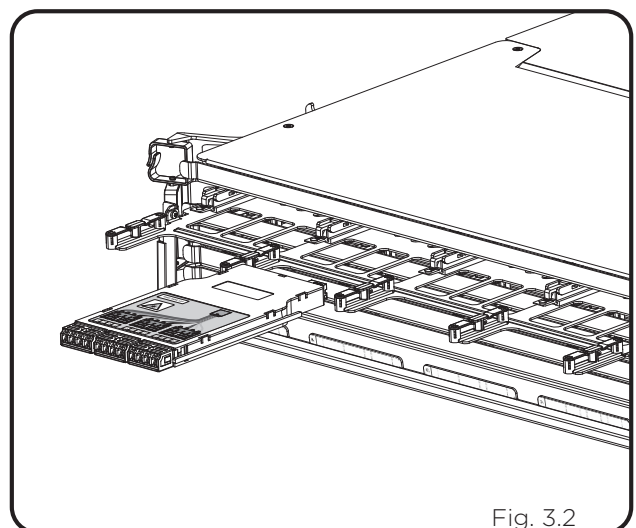

Fig. 3.2

- 3.8. When installation of the Cassette Modules is complete, lift the Swing Door until it is level; push both ends of the Swing Door forward, straight in and level, with equal force, until the Sliding Tray stops.

Note:

The Cassette Removal Lever is located on the LOWER LEFT of each Cassette Module, when viewed from the FRONT of the UHD Chassis (Front = Left).

Cassette Module Installation – Rear

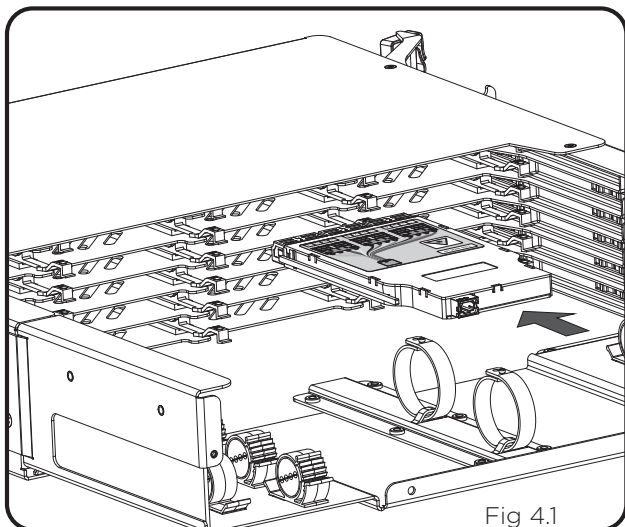

4.1. Identify the Sliding Tray location for the Cassette Module(s) installation.

4.2. Insert one Cassette Module into an empty set of Module Rails on one Sliding Tray. Ensure that the Cassette Module is correctly oriented with “This Side Up” on the top surface.

4.3. Slide the Cassette Module into the Sliding Tray until it locks into position.

4.4. Repeat as necessary until four Cassette Modules are installed into one Sliding Tray.

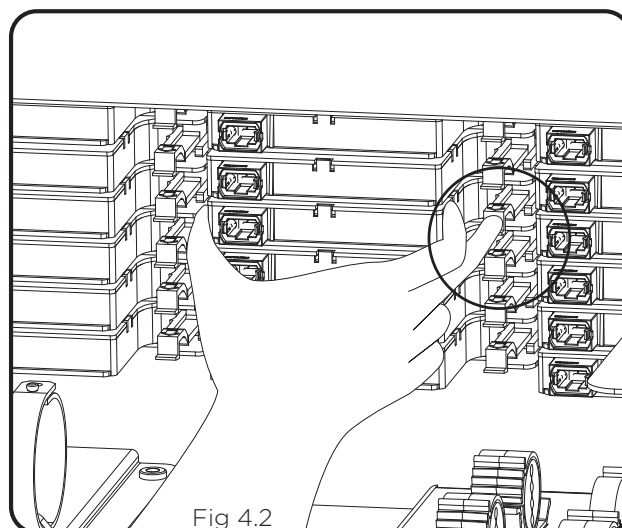

4.5. Remove a Cassette Module by pressing down the Cassette Removal Lever and pulling the Cassette Module out of the Sliding Tray. (Fig. 4.2)

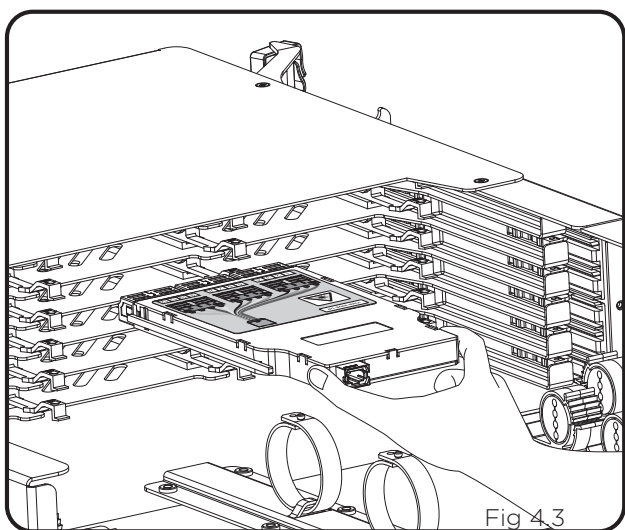

Note:

The Cassette Removal Lever is located on the LOWER RIGHT of each Cassette Module, when viewed from the REAR of the UHD Chassis (Rear = Right).

Cable Installation – Rear

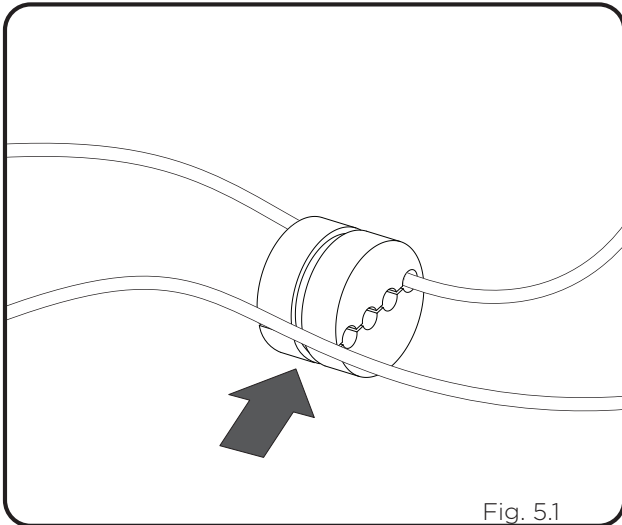

Fig. 5.1

- 5.4. Adjust the cable length of the fiber cable to allow slack.
- 5.5. Tighten the Rear Cable Clamp to secure the fiber cables. (Fig. 5.3)
- 5.6. Route the fiber cables into the Brush Grommet Entry/Exit area and out of the UHD Chassis.

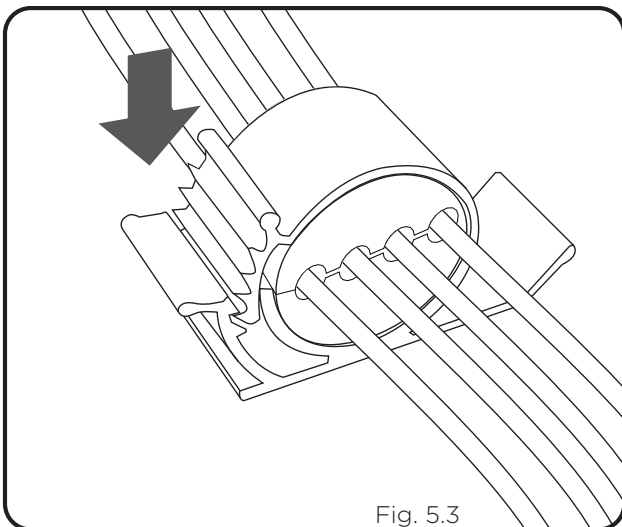

Fig. 5.3

- 5.1. Insert up to four each 2.5 - 3.5mm diameter cables into the Rubber Grommet.
- 5.2. Install the Rubber Grommet into the Rear Cable Clamp (do not tighten). (Fig. 5.2)
- 5.3. Place the Rear Cable Clamp in the UHD Chassis Extension.

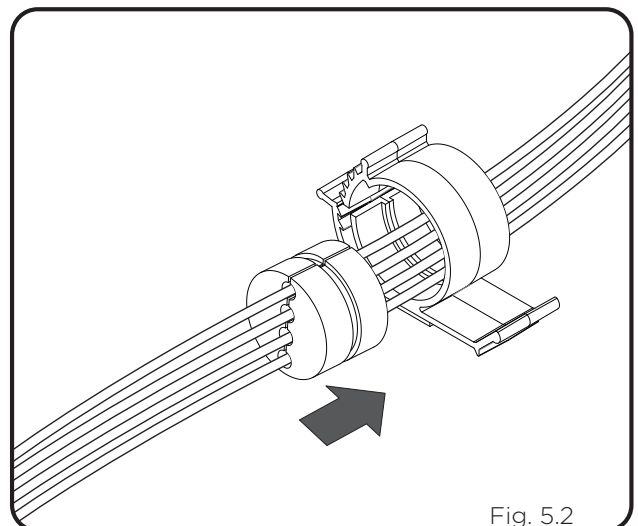

Fig. 5.2

- 5.7. Cable from the rear cable manager must be routed through the cable router before it is connected to the adapter in the rear of the cassette module.
- 5.8. Clean and connect the connector to the rear adapter of the cassette Modules.

Note:

Leave extra fiber slack to allow movement of the sliding trays

Cable Installation – Rear

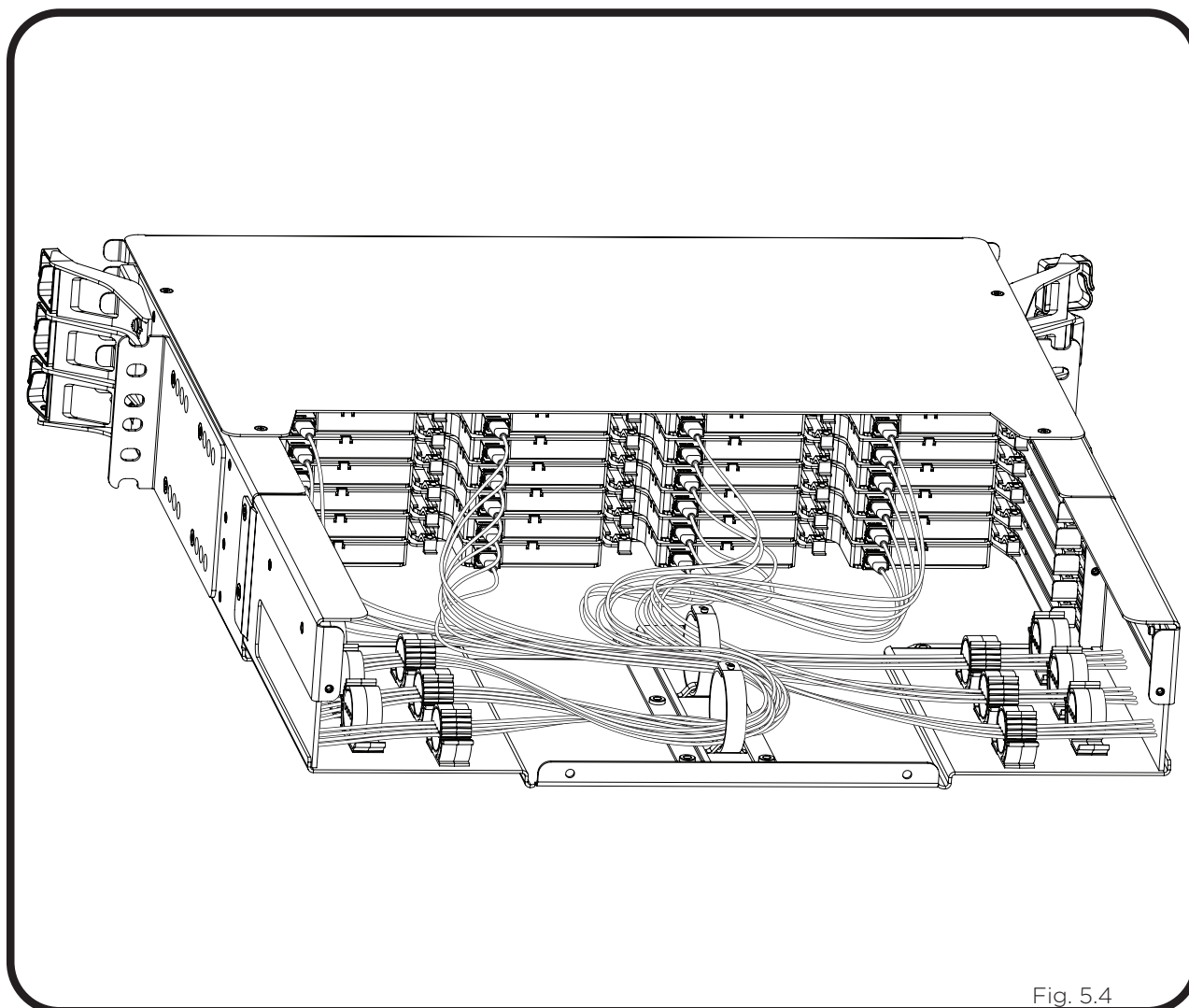

Fig. 5.4

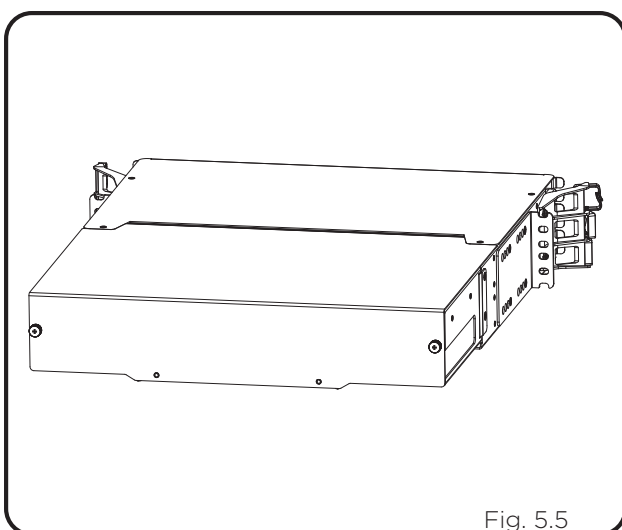

Fig. 5.5

- 5.9. Re-install the Chassis Extension Lid by sliding it onto the UHD Chassis Extension and tightening the two thumb screws on the back.

Caution:

Be cautious to avoid laser exposure while connecting the adapters.

Cable Installation – Front

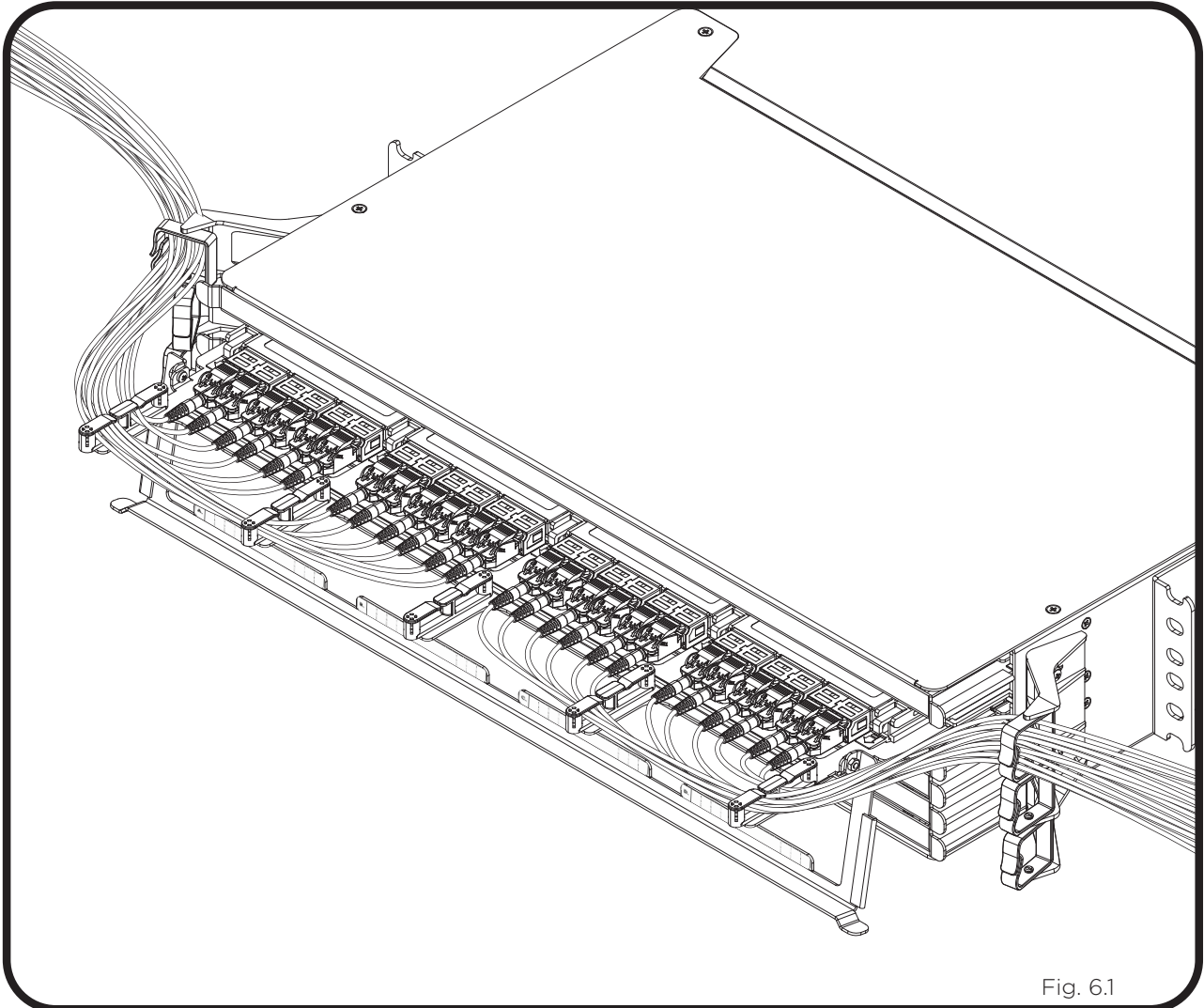

Fig. 6.1

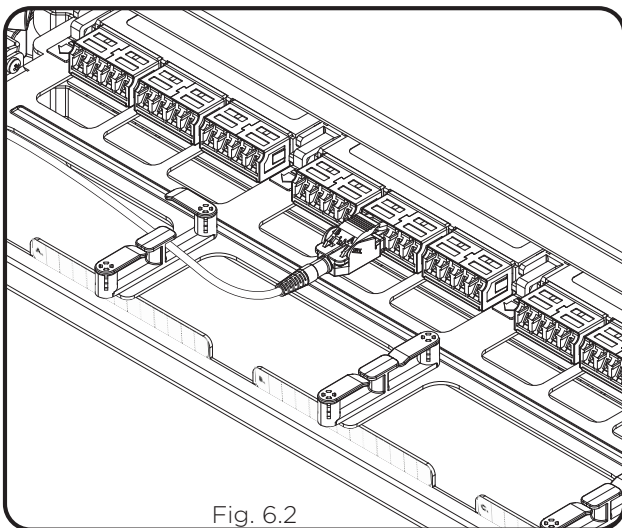
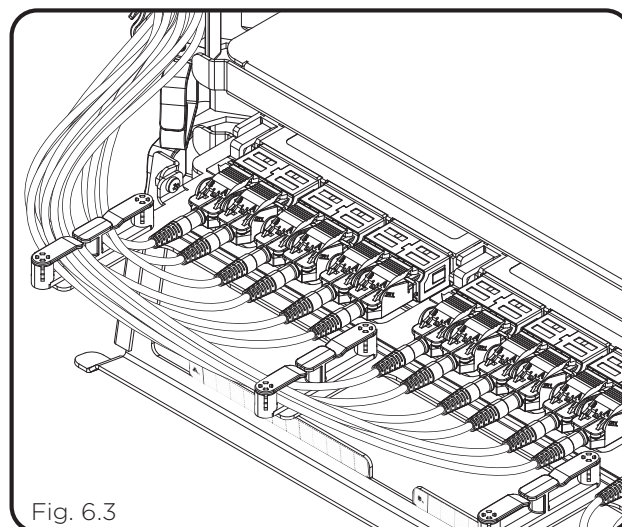

Fig. 6.2

- 6.1. Follow the procedure 3.1 through 3.3 to open the sliding tray.
- 6.2. Twist-Open the Front Cable Managers 90° on the Sliding Tray.
- 6.3. Insert and route the fiber cables to the left or to the right in the Front Cable Managers as appropriate.
- 6.4. Clean and connect the fiber cables to the Cassette Modules (Fig 6.2).

Cable Installation – Front

- 6.5. Close the Front Fiber Managers on the Sliding Tray.
- 6.6. Route the fiber cables through the Side Cable Managers on the left or right side of the UHD Chassis. (Fig 6.1)
- 6.7. Lift the Swing Door until it is level; push both ends of the Swing Door forward, straight in and level, with equal force, until the Sliding Tray stops.



Opterna Format	Yellow	Gray	Green	Blue	Heather Violet	Aqua	Black
MTP® Connector	MTP® Elite Angled OS2 (24F w/ Red Boot)				MTP® Elite OM4 (24F w/ Red Boot)	MTP® Elite OM3 (24F w/ Red Boot)	
MTP® Adapter	Opposed	Aligned			Opposed	Opposed	Opposed
LC Connector			OS2 APC	OS2 UPC	OM4 PC	OM3 PC	Tap Port
LC Adapter							

Note: Gray Aligned MTP® Adapters used in Method-B Polarity Installations



Note:

Leave extra slack for fibers while installing cassette modules.

Caution:

Be cautious to avoid laser exposure while connecting the adapters.

Extension Assembly

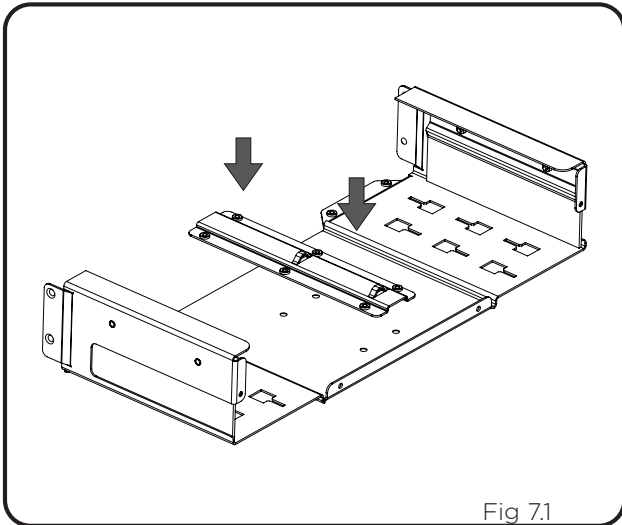

Fig 7.1

7.3. Remove the UHD lid.

7.4. Connect the extension to the UHD.

7.5. Secure the Extension to the UHD Chassis by tightening screws on both sides (2 screws on each side – Fig 7.2)

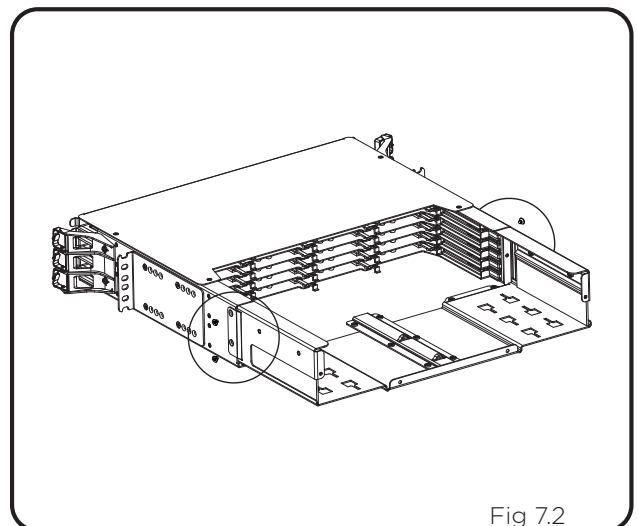

Fig 7.2

7.6. Place the UHD upside down on the surface after tightening the side screws.

7.7. Secure the Strength Member and the Extension to the UHD Chassis by installing the bottom screws (6 screws – Fig 7.3).

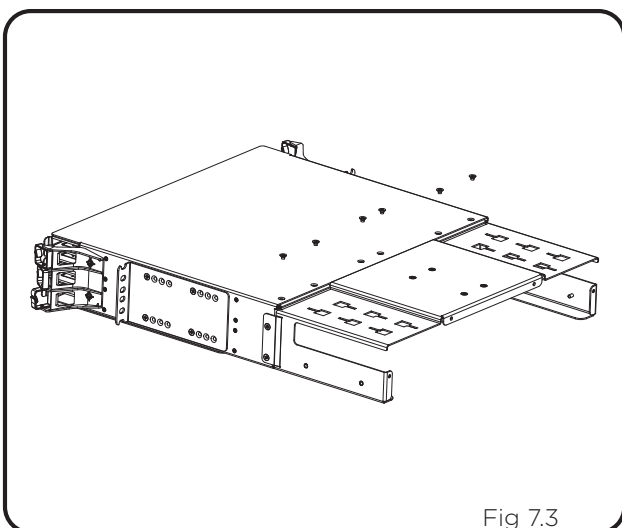

Fig 7.3

Tools Required:

Phillips-head Screwdriver

